

**USER MANUAL**

**INSTALLATION & USE**

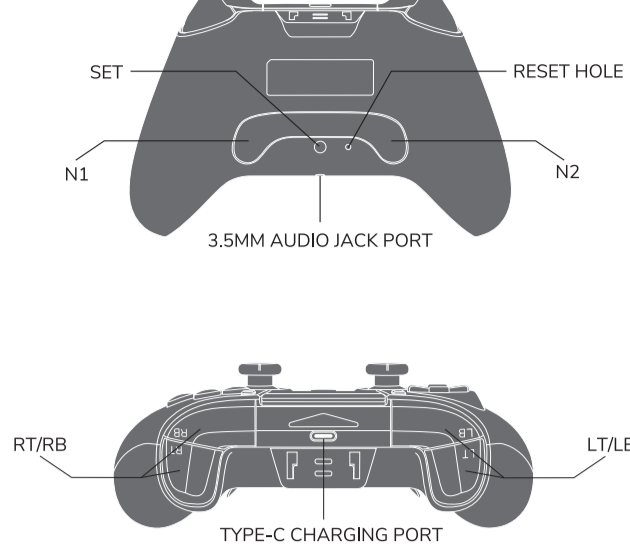
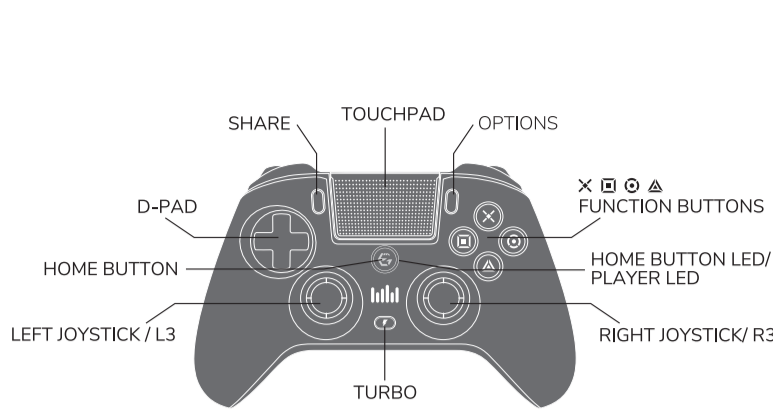

**PS4™ SETUP**

1. Use provided Type-C cable to connect the controller and PS4 console.
  2. Once connected, all LEDs light up on the controller.
  3. After 3-5 seconds, press HOME button.
  4. When successfully connected, controller icon pops up on the screen.
  5. Once connected, unplug the cable. After the first-time connection through cable, press HOME button to activate console wirelessly.
- Note** - The SC15 wireless controller is also compatible with PS5, for PS4 games only.



**PC | MOBILE SETUP**

**WIRELESS CONNECTING STEPS**

1. Turn off the controller.
2. Press and hold 'SHARE + HOME' buttons for 3-5 seconds, until HOME button LED starts flashing whilst all other LEDs are on. The controller is now in pairing mode.
3. Search for "Wireless Controller" on your Bluetooth device and select it for connection.
4. Once connected, the HOME button LED will flashing and stays on.

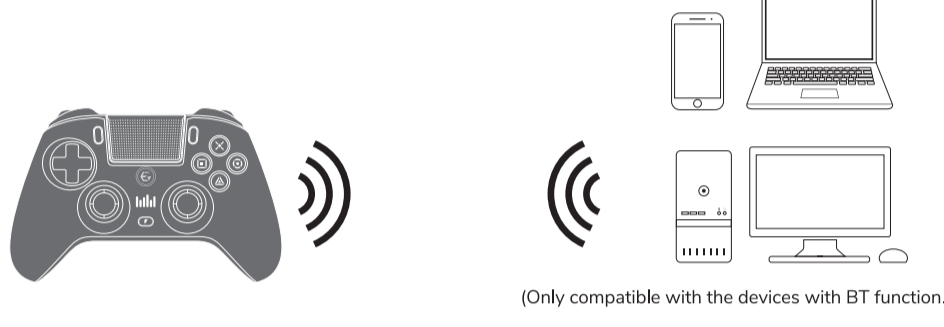

**WIRED CONNECTING STEPS**

1. Use the provided Type-C cable to connect the controller and PC.
2. Once connected, all LEDs light up.
3. The controller now is recognized as a X-input controller device.

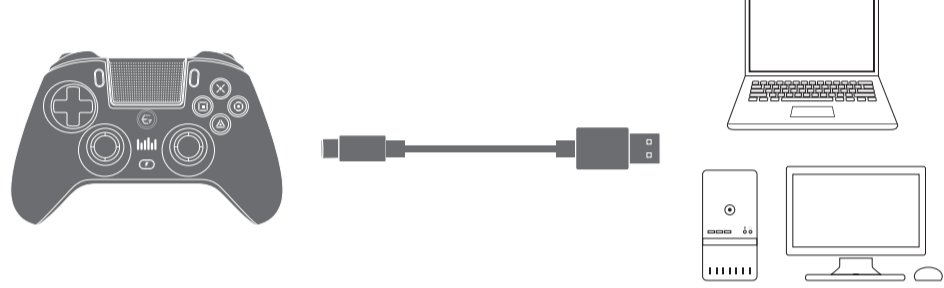

**SWITCH TO D-INPUT MODE**

Press and hold 'SHARE + OPTIONS' buttons for 3~5 seconds, HOME button LED lights up.  
 - X-INPUT: XBOX 360 Controller for Windows  
 - D-INPUT: SC15 Wireless Controller

**TURBO**

**Support buttons** - X, O, T, A, LT/LB, RT/RB, N1, N2  
**Setup** - Example, set LT as turbo.  
**Shoot** - Press and hold 'TURBO + LT'.  
**Clear turbo** - Press and hold 'TURBO + LT' again.



**SPEED ADJUSTMENT**

**High** - Press and hold the TURBO button, and press R3 towards up direction.



**Low** - Press and hold the TURBO button, and press R3 towards down direction.

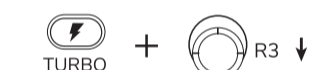

**TOUCHPAD**

**Action** - activates an in-game command (depending on the game settings)

**MACRO PROGRAMMING**

**Support buttons** - X, O, T, A, LT/LB, RT/RB, L3, R3, N1, N2

**Setup**

1. Press SET button for 2 seconds.
2. The HOME button LED flashes.
3. Press any button or combined buttons you would like programmed.
4. Press the back button you would like to programme a function.
5. The HOME button LED will stays on once setup successfully.

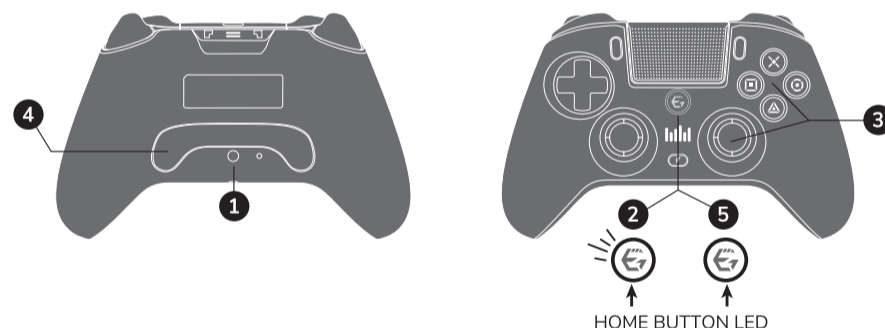

**Clear**

1. Press SET button for 5 seconds, the HOME button LED flashes.
2. When HOME button LED stops flashing and stays on, release SET button.
3. Programmed buttons now cleared successfully.

**Note:** The programming buttons have memory function.

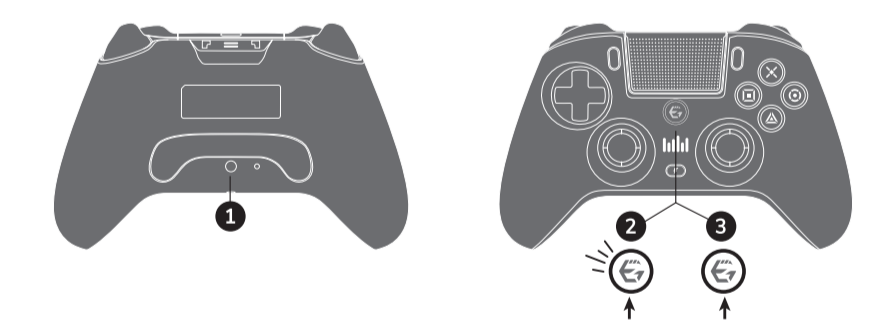

**CHARGING**

**When charging** - HOME button LED flashes slowly.  
**Once fully charged** - HOME button LED off.

\*When playing through wired mode, the controller will be charged by the computer or console.

**PLAYER LED INDICATION**

**Players** - Press HOME button to identify players.  
 Blue for Player 1 / Red for Player 2 / Green for Player 3 / Pink for Player 4

**RGB LEDS CONTROL**

1. Press the SET button to switch through different colour settings: RGB MIX WAVE, BLUE, RED, GREEN, PINK, ORANGE, CYAN, PURPLE, OFF.
2. The controller memorises the last LED settings.

**CONTROLLER SETTINGS**

Speaker volume and other controller settings.  
**Option 1:** Select 'Settings' from the screen > select 'Devices' > Controllers.  
**Option 2:** Press and hold the HOME button > select 'adjust sound and devices' from the quick menu appears on screen.

\*There might be audio sound effects from the controller speaker depends on the game or application.

**RESET**

If you experience the controller dysfunctional, please reset the controller.  
 Please use a pin, press and hold on the small hole on the back of the controller for 3-5 seconds.

**FIRMWARE UPDATE**

- Firmware update instruction available on [www.egogear.com](http://www.egogear.com)
- Find and select SC15 Wireless Controller.
- Click 'Download' and follow the instructions on the screen.

**SPECIFICATIONS**

- Type-C charging cable: 2m
- Wireless connection: Bluetooth 5.3
- Bluetooth transmission distance: ≈ 10m
- Battery type: Li-ion
- Battery capacity: 800 mAh
- Charging hour: 3.5h
- Play hour: 8h
- Input power rating: DC5V/ 500mA
- Voltage: 5 V+/-0.2 V
- Operating temperature: -10 C ---60 C
- Radio frequency: ISM 2.4G
- Frequency band: 2402---2480MHz(1MHz)
- Maximum radio-frequency: 0dbm
- Mass: Approx. 223g